

File name: \\EU\AECOM\NET\COM\MEMIA\KUI\EBL2\JOBS\PR-447455\_BLESSINGTON\_GREENWAY\1900\_CAD\20-SHEETS\LACKAN\60617025\_SHT\_BLGWY\_146\_LACKAN\_PC\_PLAN AND PROFILE.DWG  
 Last saved by: PATRICK CRAIG Last Plotter: 2023-12-15

ORDNANCE SURVEY IRELAND LICENCE NO CYAL50317588  
 ©ORDNANCE SURVEY IRELAND / GOVERNMENT OF IRELAND

ISO A1 594mm x 841mm  
 Approved: EOM  
 Checked: MC  
 Designer: CL  
 Project Management Initials:

**KEY:**

- PROPOSED GREENWAY
- PROPOSED GRASS VERGE
- PROPOSED HARDENED VERGE
- PROPOSED EARTHWORKS FILL
- PROPOSED EARTHWORKS CUT
- BLESSINGTON LAKE
- PROPOSED WATER CROSSING STRUCTURE
- PROPOSED RETAINING SOLUTION
- PROPOSED ROCK ARMOUR
- EXISTING FENCE LINE
- PROPOSED FENCE LINE
- PROPOSED PICNIC AREA
- PROPOSED VIEWING AREA
- PROPOSED EMERGENCY ACCESS

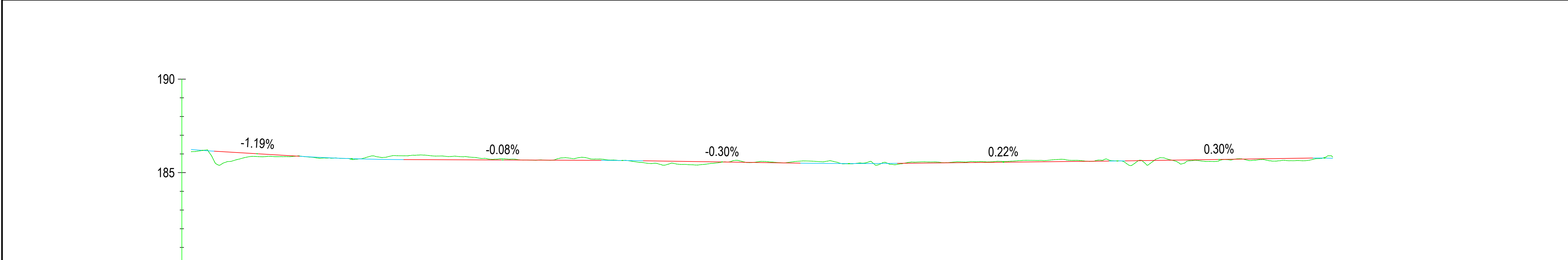
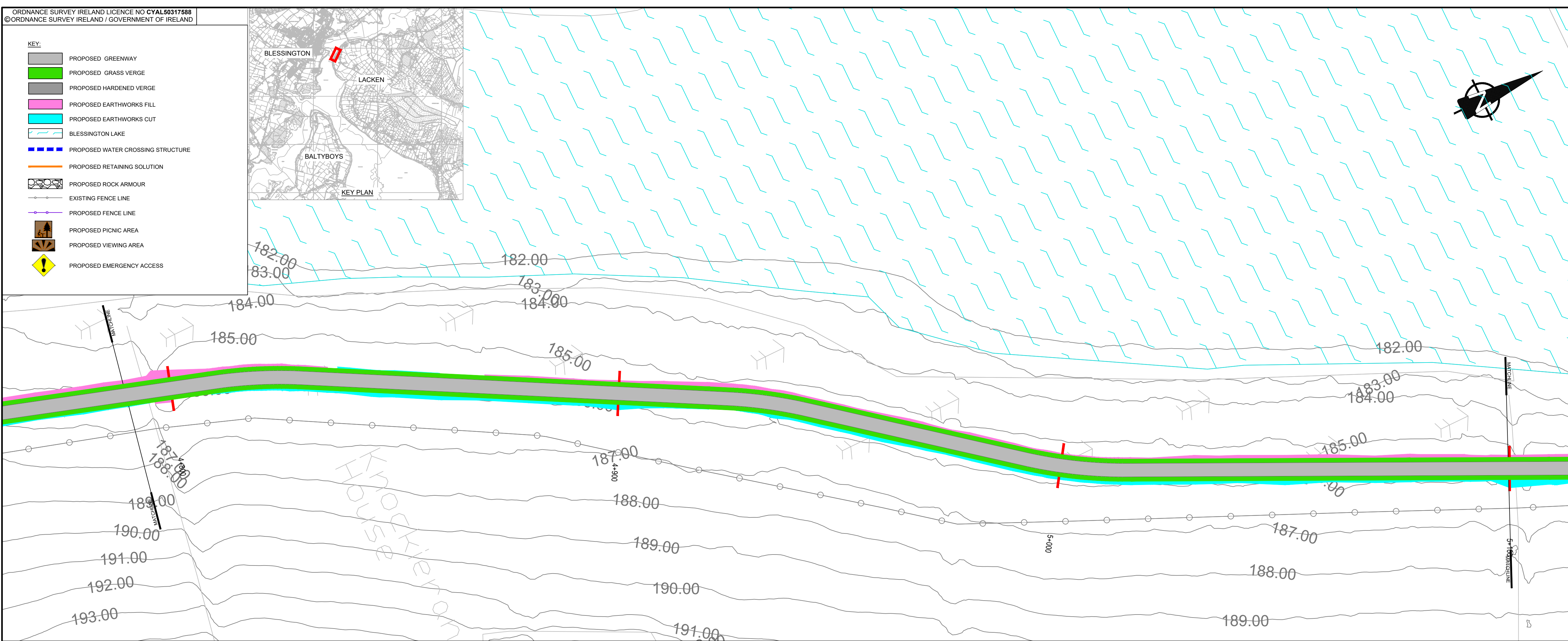

CHAINAGE	4790.000	4800.000	4850.000	4900.000	4950.000	5000.000	5050.000	5095.000				
EXISTING LEVELS	186.118	185.593	185.931	185.715	185.558	185.586	185.785	185.834				
PROPOSED LEVELS	186.238	186.100	185.695	185.655	185.516	185.542	185.660	185.768				
VERTICAL ALIGNMENT	L=6.301 K=10.00 G=-1.19% -1.84,0		L=27.797 K=25.00 G=-0.08% -1:1268.4		L=11.15 K=50.00 G=-0.30% -1:331.2		L=25.857 K=50.00 G=0.22% 1:464.7		L=4.239 K=50.00 G=0.30% 1:333.4		L=6.11 K=5.00	



**PROJECT**

**BLESSINGTON  
eGREENWAY**

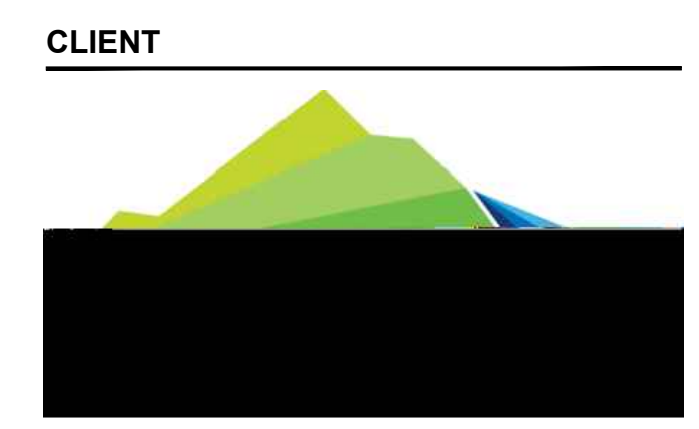

**CONSULTANT**

AECOM  
 DOUGLAS BUSINESS CENTRE  
 CARRIGLINE ROAD  
 DOUGLAS  
 CORK  
 Tel: +353 (0)21 436 5006  
 www.aecom.com

- NOTES**
- THIS DRAWING IS TO BE READ IN CONJUNCTION WITH ALL OTHER RELEVANT ENGINEERING DRAWINGS, ANY DISCREPANCIES, ERRORS OR OMISSIONS TO BE BROUGHT TO THE ATTENTION OF THE EMPLOYER.
  - ALL DIMENSIONS TO BE CHECKED BY THE CONTRACTOR ON SITE PRIOR TO COMMENCEMENT OF WORKS.
  - EMPLOYER'S REPRESENTATIVE TO BE INFORMED BY THE CONTRACTOR OF ANY DISCREPANCIES PRIOR TO THE COMMENCEMENT OF WORKS ON SITE.
  - DIMENSIONS OF ALL BOUNDARIES AND ADJOINING ROADS TO BE CHECKED ON SITE PRIOR TO COMMENCEMENT OF WORKS.
  - DO NOT SCALE. ALL MEASUREMENTS AND COORDINATES TO BE CHECKED ON SITE.
  - EXISTING FENCE LINES ARE INDICATIVE AND ARE TO BE CONFIRMED ON SITE. EXISTING FENCING IS TO BE REVIEWED ON SITE AND REPLACED WHERE REQUIRED.
  - EMERGENCY ACCESS POINTS ARE TO BE CLOSED OFF WITH DEMOUNTABLE BOLLARDS. KEYS TO BE HANDED OVER TO THE OVERSEEING ORGANISATION.
  - EGREENWAY DRAINAGE IS TO BE OVER THE EDGE DRAINAGE.
  - PROPOSED FENCELINE TO BE ERECTED IN ACCORDANCE WITH TII STANDARD DETAIL CC-SCD-00303.

**ISSUE/REVISION**

I/R	DATE	DESCRIPTION
2	DEC 2023	ABP RFI UPDATE
1	MAY 2023	ABP RFI UPDATE
0	OCT 2021	ISSUED FOR PLANNING

**PROJECT NUMBER**

60617025

**SHEET TITLE**

PLAN AND PROFILE  
 LACKAN  
 SHEET 16 OF 18

**SHEET NUMBER**

60617025\_SHT\_DD\_BLGWY\_146.16

This drawing has been prepared for the use of AECOM's client. It may not be used, modified, reproduced or relied upon by third parties, except as agreed by AECOM or as required by law. AECOM accepts no responsibility, and denies any liability, whatsoever, to any party that uses or relies on this drawing without AECOM's express written consent. Do not scale this document. All measurements must be obtained from the stated dimensions.